

2023 JAPANESE GRAND PRIX

22 - 24 September 2023

From	The FIA Formula One Race Director	Document	2
To	All Teams, All Officials	Date	21 September 2023
		Time	12:15

Title Event Notes - Circuit Map, Pit Lane Drawing and Red Zone

Description Circuit Map, Pit Lane Drawing and Red Zone

Enclosed JPN DOC 2 - Circuit Map Pit Lane and Red Zone.pdf

Niels Wittich

The FIA Formula One Race Director



FIA Formula 1
World Championship™

FORMULA 1 LENOVO JAPANESE GRAND PRIX 2023 - Suzuka

Circuit Map

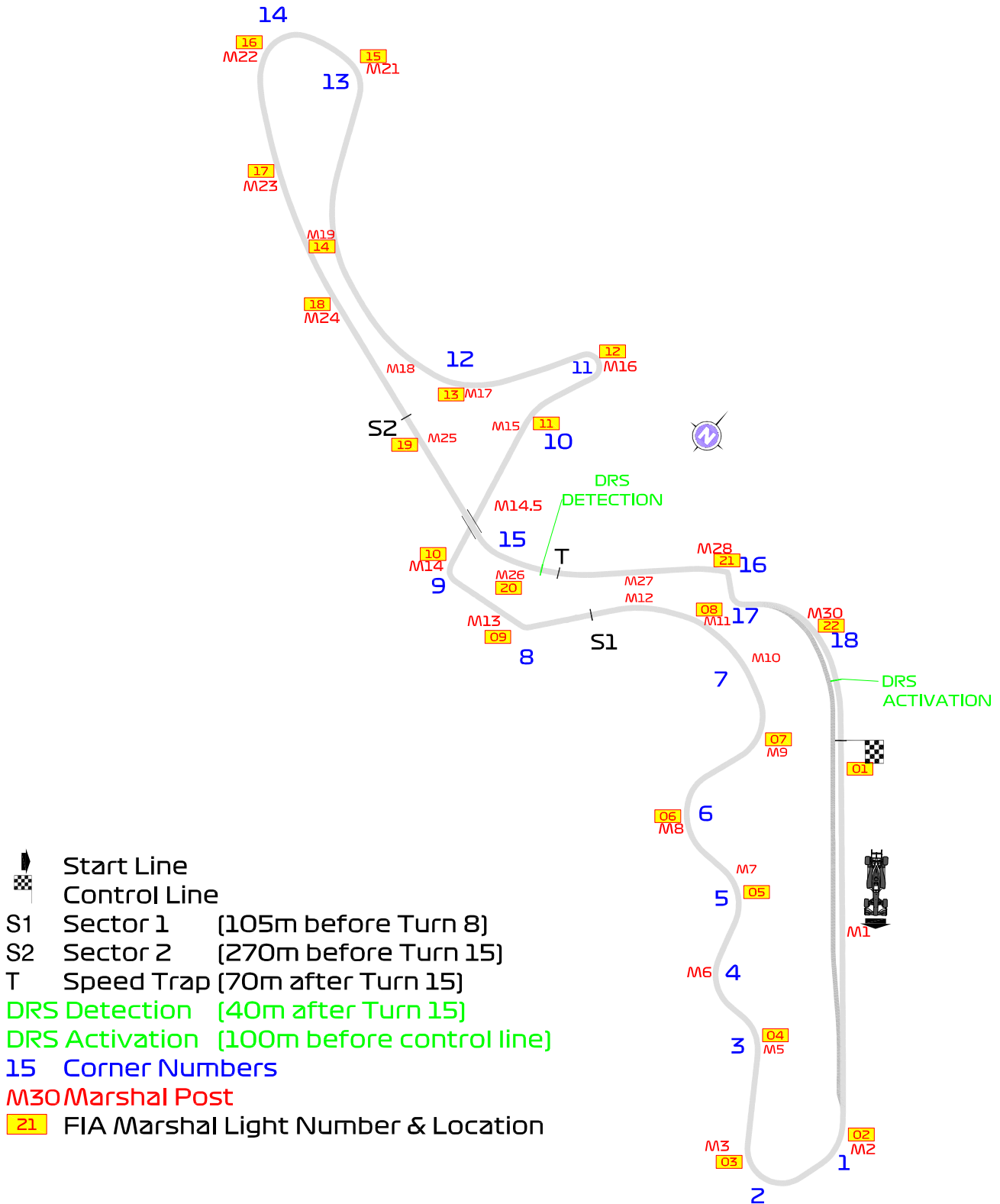

- Start Line
- Control Line
- S1 Sector 1 (105m before Turn 8)
- S2 Sector 2 (270m before Turn 15)
- T Speed Trap (70m after Turn 15)
- DRS Detection (40m after Turn 15)
- DRS Activation (100m before control line)
- 15 Corner Numbers
- M30 Marshal Post
- FIA Marshal Light Number & Location

Circuit Centreline Length = 5.807km

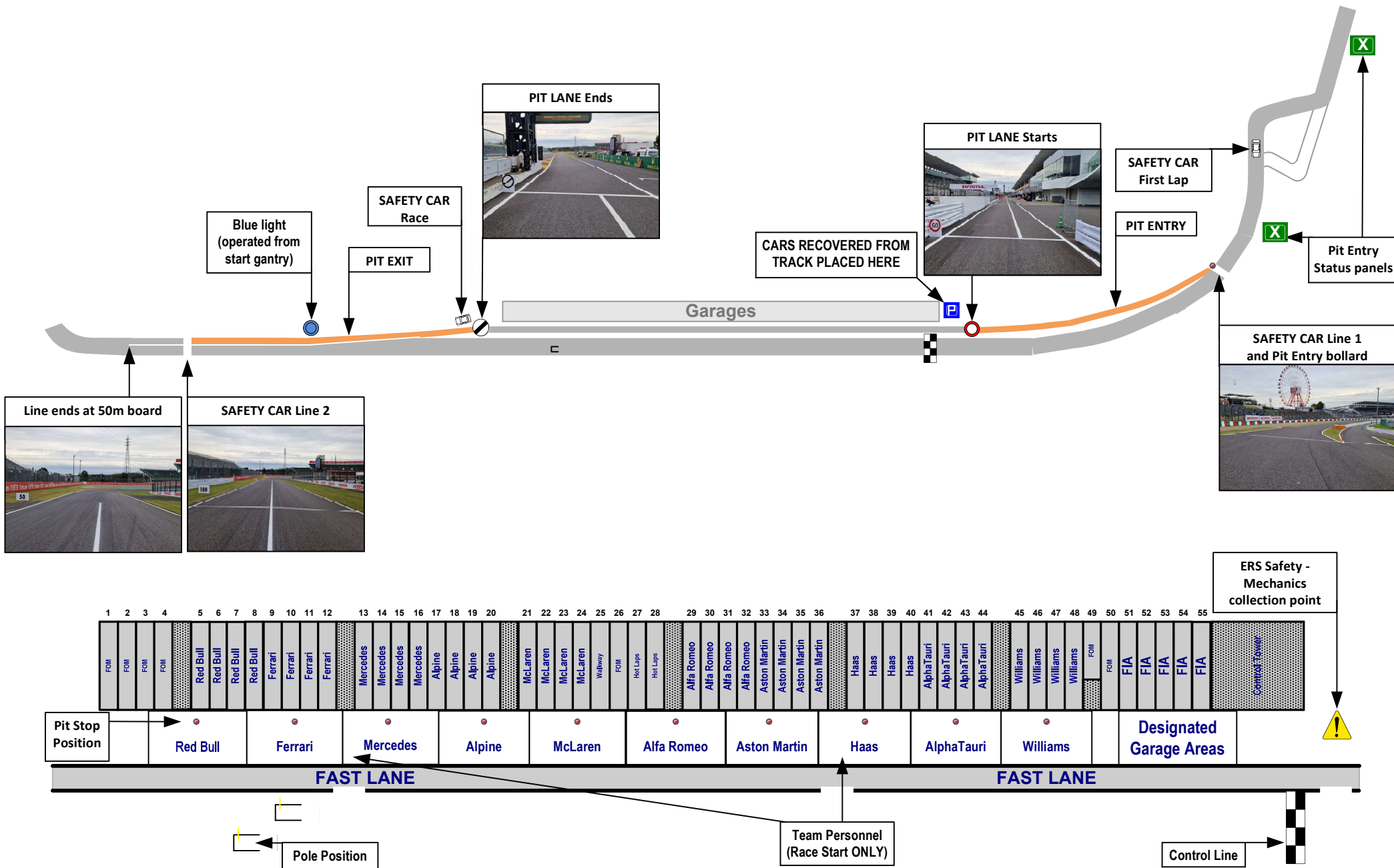



FORMULA 1 LENOVO JAPANESE GRAND PRIX 2023 - SUZUKA

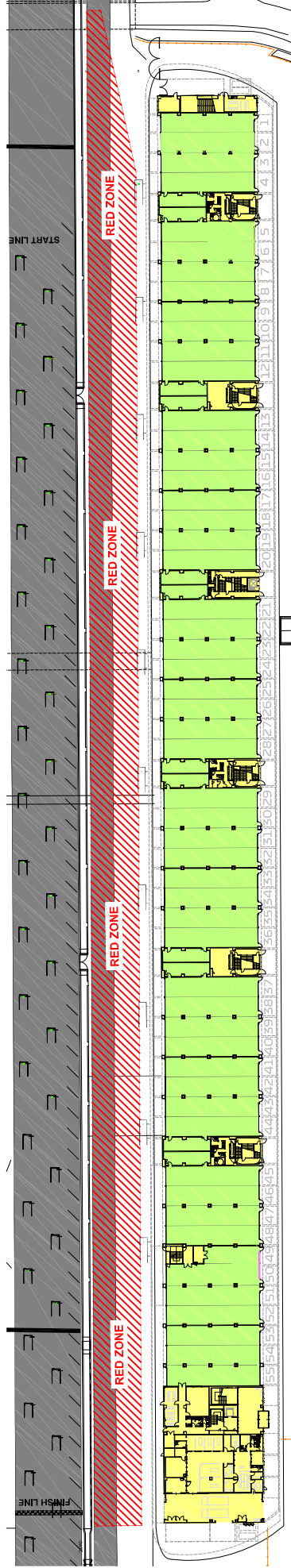

PHOTOGRAPHERS EXCLUSION RED ZONE